

NEW EFGC SERIES GEAR COUPLINGS

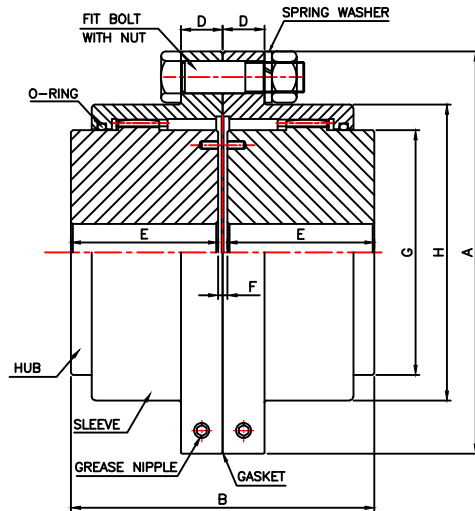

FULL FLEXIBLE

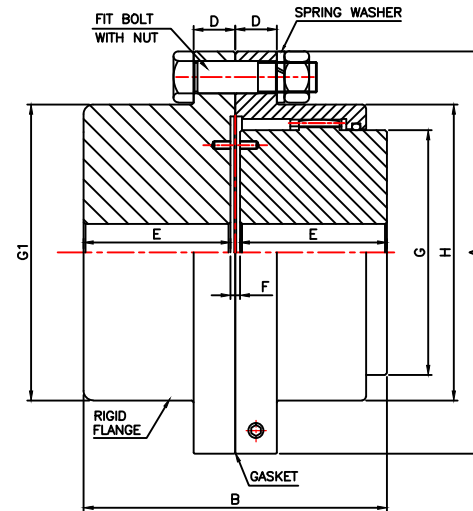

HALF RIGID

TECHNICAL AND DIMENSIONAL INFORMATION

SL NO	COUP SIZE	POWER AT 100 RPM (KW)	CONTINUIOUS TORQUE (NM)	BORE RANGE				DIMENSIONS (MM)										MAX SPEED (RPM)	NO OF BOLTS	SIZE OF BOLTS	MAX MISALIGNMENT			APPROX WT(KG)	
				MIN	MAX	PB	MAX IN RIGID	A	B	D	E	F	G	G1	H	PARALLEL(MM)	AXIAL(MM)				ANGULAR	FULL FLEX	HALF FLEX		
1	EFGC1	14.1	1350	15	45	12	55	113	93	14	45	3	66	78	80	7000	6	MBX38	±0.4	±0.5	1.5°	4.5	4.4		
2	EFGC2	29.8	2850	20	60	18	75	144	105	19	51	3	86	101	104	6200	8	M10X50	±0.4	±0.5	1.5°	8.5	8.6		
3	EFGC3	53	5060	30	75	28	95	174	130	18	63.5	3	105	126	130	5650	6	M12X55	±0.8	±0.5	1.5°	15	14.9		
4	EFGC4	105	10000	35	95	32	110	212	160	22	77.5	5	129	152	156	5100	6	M16X65	±0.8	±0.5	1.5°	27	26.8		
5	EFGC5	168	16050	40	110	36	130	234	185	22	90	5	151	178	181	4700	8	M16X65	±1.0	±0.5	1.5°	37.8	38.4		
6	EFGC6	231	22010	55	130	52	155	274	216	29	105	6	178	208	209	4350	8	M20X85	±1.0	±1.0	1.5°	60.8	63.7		
7	EFGC7	335.7	32064	65	155	60	180	312	246	29	120	6	213	245	247	4000	8	M20X85	±1.2	±1.0	1.5°	90.7	95.7		
8	EFGC8	472	45072	80	175	75	200	337	278	29	135	8	235	271	273	3800	10	M20X85	±1.2	±1.0	1.5°	118.7	124.8		
9	EFGC9	650	62078	90	195	85	230	380	308	38	150	8	263	306	307	3600	10	M20X105	±1.3	±1.0	1.5°	168.6	177.2		
10	EFGC10	880	84100	100	215	95	240	405	358	38	175	8	286	330	338	3450	14	M20X105	±1.5	±1.0	1.5°	230	236		
11	EFGC11	1125	115000	115	235	110	260	448	400	38	195	10	315	376	382	2300	14	M20X105	±1.5	±1.0	1.5°	312	320		
12	EFGC12	1700	174000	150	275	140	300	510	450	28	220	10	376	430	440	2200	14	M24X85	±1.5	±1.0	1.5°	443	455		
13	EFGC13	2600	275000	180	280	170	315	405	358	30	265	10	400	470	494	1900	16	M24X90	±1.5	±1.0	1.5°	590	605		

JK Fenner (India) Ltd.

Engineering Product Division

- # ALL DIMENSIONS ARE IN MM
- # COMPACT DESIGN
- # GREASE PLUG IS PROVIDING FOR LUBRICATION
- # AVAILABLE IN FINISH & PILOT BORE
- # IT IS RECOMMENDED TO USE COUPLING GUARD FOR BETTER SAFETY